

GUARDIAN OF THE GRAVE™

GUARDIAN OF THE GRAVE™ Setup instructions:

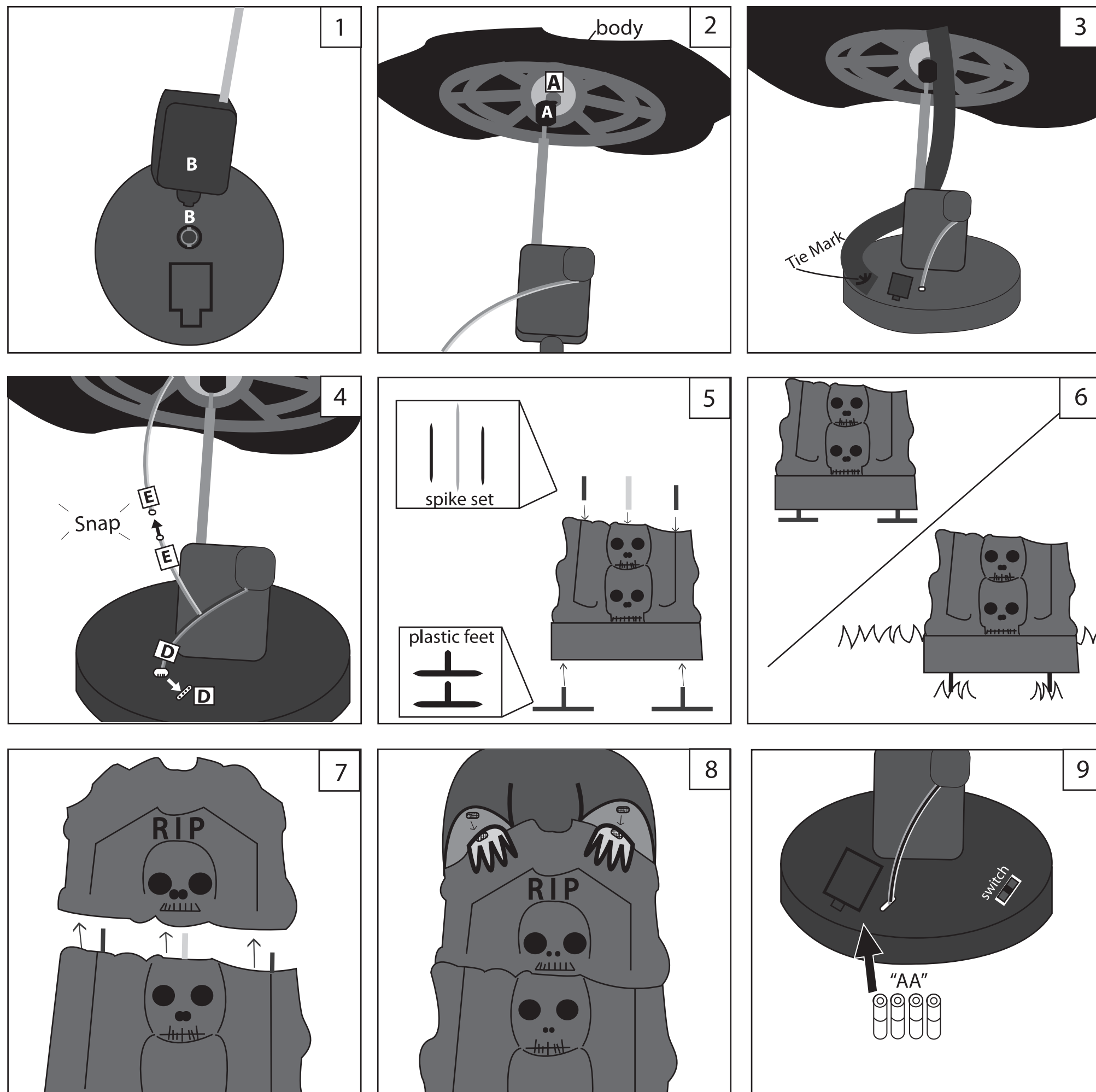

1. Assemble TELESCOPING MODULE (Line up B to B) into BASE. Twist to lock.
2. Assemble SHOULDERS to TELESCOPING MODULE (Line up A to A). Twist to lock.
3. Twist tie FOG TUBE to BASE making sure to mount at area marked 'Tie Mark' on FOG TUBE.
4. Connect wires labeled PART D (Line up D to D), and PART E (Line up E to E). Snap connect all wiring.
5. Insert 3 SPIKES into pre made holes in TOP half of TOMBSTONE. Keep METAL SPIKE in Center.
6. Insert PLASTIC FEET into BOTTOM half of tombstone making sure to **keep feet level, or TOMBSTONE will not stand straight!!** Feet can also be turned to insert into soft ground.
7. Connect TOP half to BOTTOM half of TOMBSTONE.
8. Set TOMBSTONE directly in front of GUARDIAN and velcro GUARDIAN'S SLEEVES to TOMBSTONE keeping TOMBSTONE very close to GUARDIAN.
9. Insert 4AA batteries into battery compartment located on BASE and turn switch to 'ON' position to activate. Guardian is timed to activate every 2 minutes unless a loud sound overrides the 2 minute break. Guardian will also work with optional DC adapter. (6V 2A DC adapter not included, go to www.tekkytoys.com to purchase)
*****NOTE:** If GUARDIAN does not rise up to face forward, loosen twist-tie, and rotate fog tube slightly to allow GUARDIAN to face the proper direction. Then, re-tighten twist-tie.

STOP DO NOT RETURN THIS ITEM TO THE STORE!
 If experiencing technical difficulties, please go to www.tekkytoys.com.

GUARDIAN OF THE GRAVE™

OPTIONAL FOG MACHINE Setup Instructions:

FOG MACHINE IS NOT INCLUDED. MUST BE PURCHASED SEPARATELY.

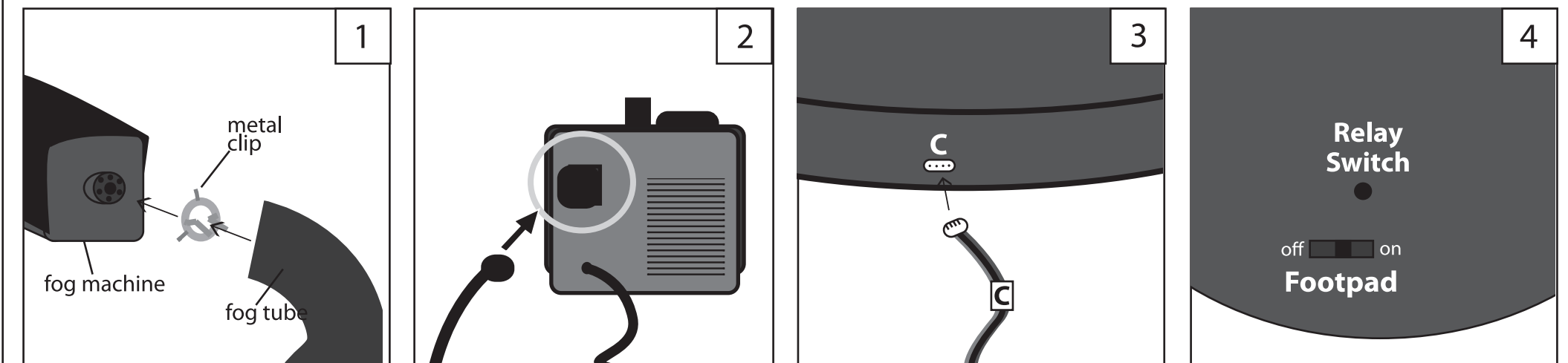

Optional Fog Attachment setup:
 Your FOG MACHINE (select models) can be used in connection with the Guardian.
 Only attach a FOG MACHINE as instructed below.

***** Make sure Guardian is set to the OFF position and your FOG MACHINE is not turned on*****

1. Install METAL CLIP and FOG TUBE onto your FOG MACHINE.
 (Note: leave about 1.5 inches space between fog machine nozzle and the end of the tubing, or tube may melt).
2. Plug the Guardian's FOG CORD into your FOG MACHINE. IF FOG CORD will not plug in, or your machine does not interface with the Guardian, we recommend that you not use optional fog attachment.
3. Plug other end of FOG CORD into BASE of Guardian (Attach C to C).
4. Make sure your FOG MACHINE is heated up properly, then turn GUARDIAN switch to ON position. If fog does not appear from mouth, try pressing the relay switch on the BASE.

Optional Footpad Setup

Follow Steps 1 through 8 on initial installation first.

1. Connect wire from the optional footpad to the jack labeled FOOTPAD located on the base.
2. Place the switch on the base into the 'FOOTPAD' position to enable FOOTPAD activation.
3. Step on FOOTPAD to activate the scary sequence. (go to instruction #9 to continue setup)

NOTE:

When plugging in, make sure pins line up properly with holes on plug. Align plug, groove side down, with the notch.

CAUTION!

Not aligning the plug to jack properly may cause permanent damage to Foot Pad jack of your item. Do not use excessive force when inserting plug.

*Footpads are sold separately and can be purchased at www.tekkytoys.com

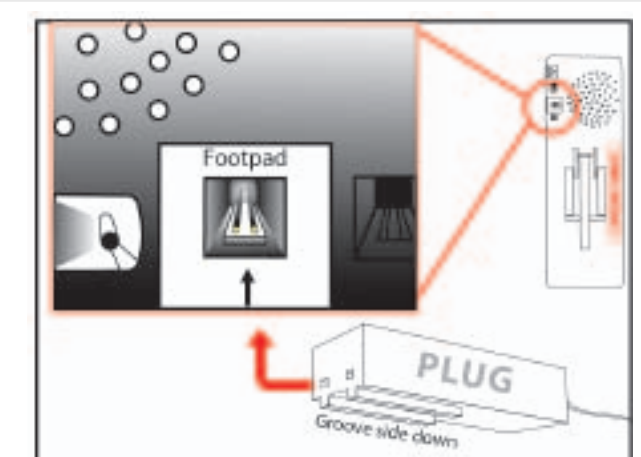

Caution:

Do not touch the Guardian, cords, or any part connected to Guardian when it is plugged in.

Do not operate the Guardian in wind/rain.

Do not operate the Guardian until you have completely finished assembly.

For best overall performance, please shut off the Guardian when not in use.

Do not tamper with MODULE or FOG CORD whatsoever. Warranty voided if any part is tampered with.

USE SAFETY when using Fog Machine attachment, and strictly adhere to all printed Fog Machine Warnings.

***** No weight should be placed on the item. *****

Warning! This item is not a toy. For decoration only. Small parts, choking hazard.

This product is intended for use by persons 15 years of age and older.

Not intended for use by children ages 14 years and younger.

STOP DO NOT RETURN THIS ITEM TO THE STORE!
 If experiencing technical difficulties, please go to www.tekkytoys.com.