

SITTING WITCH™

INSTALLATION AND OPERATING INSTRUCTIONS

KEEP ALL PLASTIC AND WIRE PARTS AWAY FROM CHILDREN

WARNING: DO NOT TURN ON THE PROP UNTIL FULLY ASSEMBLED: STAY CLEAR OF THE PROP WHILE OPERATING



Parts:

A: BOWL

B: POLE

C: HEAD WITH CLOTHES & BASE

D: 6V2A ADAPTER

Assembly:

1. Locate the opening on the back of Sitting Witch's robe and insert POLE into back of HEAD WITH CLOTHES & BASE. Snap lock the POLE into the base of the neck. (Match A to A) Press POLE until it clicks into place. Insert POLE into BASE. (Match B to B) Press until it clicks into place.
 2. Connect wires located on BASE to wire located on BOWL. (Match C to C)
 3. Attach three hook and loop fasteners on the front of the dress to the LOWER hook and loop located on the bowl.
- *Note: Bowl must be level, and have a light source above the bowl to enhance the motion sensor function.*
4. Attach hook and loop fasteners located on the inside of both sleeves to the UPPER hook and loop fasteners on both sides of the bowl.
 5. Attach hook and loop fastener (located on the inside of the Witch's CLOTHES above the rear of the base) to the hook and loop fastener located on the bottom of the BASE.
 6. Place the lace fabric down and over the lap.
 7. Reach into the back of the dress above the base, and Connect 6V2A ADAPTER (included) or insert 4 AA alkaline batteries (not included) into the battery compartment located on the BASE.
 8. Reach into the back of the dress above the base, and turn the switch to the ON position to operate in Sound and Motion activation mode. Any sound or motion inside the candy bowl will activate the item. For MOTION ONLY, only motion inside the candy bowl will activate the item. Turn item OFF when not in use. Adjust volume control knob as needed.

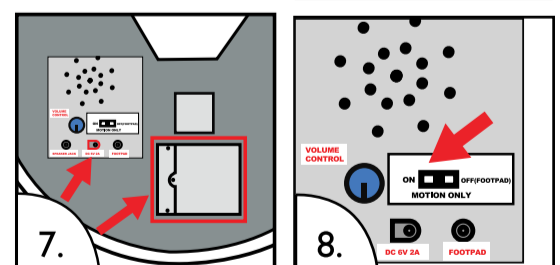
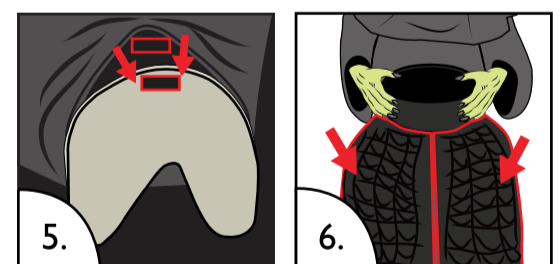
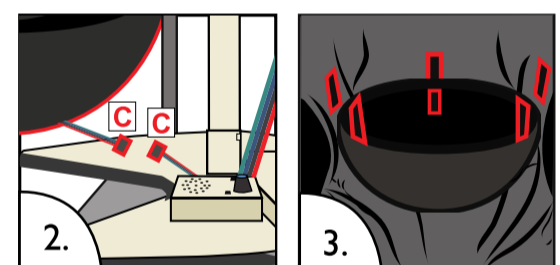
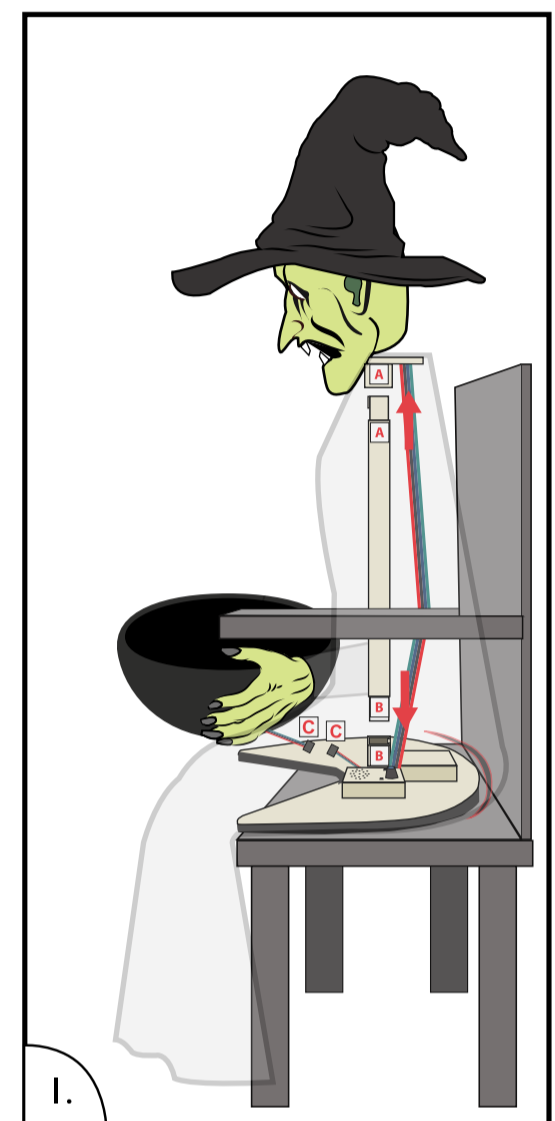

OPTIONAL EXTERNAL SPEAKER SET UP
EXTERNAL SPEAKER IS NOT INCLUDED. MUST BE PURCHASED SEPARATELY.

1. Plug speaker cord into the jack labeled SPEAKER JACK located on top of the base.
2. Use volume knob on external speaker to control volume levels.

OPTIONAL FOOTPAD SET UP

1. Connect the cable from optional footpad.
2. Place the switch in the FOOTPAD position to enable FOOTPAD activation
3. Step on the FOOTPAD to activate the scary sequence!

Footpads, adapters and all other accessories are sold separately and can be purchased at www.tekkyaccessories.com



visit us at tekkydesign.com

Requires 6V 2A ADAPTER (included) or 4 AA batteries (not included)

ALL NEW MATERIALS:
METAL, FOAM, PLASTIC, POLYESTER
Surface washable only.

SITTING WITCH™ is a trademark of Tekky.
Copyright © 2017 Tekky.
All Rights Reserved.
MADE IN CHINA

BATTERY INSTRUCTIONS AND CAUTIONS
Battery installation and removal should be performed by an adult. Remove batteries when not in use. Use only batteries recommended in the instructions. Do not mix new and used batteries. Do not mix alkaline, carbon-zinc, nickel-cadmium, rechargeable or different types of batteries. Be mindful to insert batteries with the correct polarity (+/-) as indicated. Remove all exhausted batteries. Rechargeable batteries are only to be charged under adult supervision. Rechargeable batteries are to be removed from the item before being charged. Non-rechargeable batteries are not to be recharged. The supply terminals are not to be short-circuited. Always dispose of exhausted batteries properly. Do NOT dispose of batteries in fire, they may leak or explode.

Warning! This item is not a toy. For decoration only. Small parts, choking hazard. This product is intended for use by persons 15 years of age and older. Not intended for use by children ages 14 years and younger.

WARNING
DO NOT TURN ITEM ON UNTIL YOU HAVE COMPLETELY FINISHED ASSEMBLY.
STAY CLEAR OF ITEM WHILE OPERATING.
DO NOT PLACE ITEM ON UNEVEN GROUND.
DO NOT PLACE WEIGHT ON ITEM WHILE IN OPERATION.
** FOR INDOOR USE ONLY**



DO NOT RETURN THIS ITEM TO THE STORE!
If experiencing technical difficulties, please go to www.tekkydesign.com for assistance.

SMART PHONE SCAN
SETUP VIDEO

